



Keeping You Connected.



SEMI PREMIUM CONNECTIONS  
FIELD TESTED. FIELD PROVEN.

## Precision Connections BK

### 4.5 in. 15.1 lb/ft P-110 with 5 in. Coupling OD

#### Pipe Body

Nominal OD	4.500	inches
Nominal Weight	15.10	lb/ft
Wall Thickness	0.337	inches
Plain End Weight	14.98	lb/ft
Drift	3.701	inches
Nominal ID	3.826	inches
Grade	P-110	
Min Yield	110,000	lbf/in <sup>2</sup>
Min Tensile	125,000	lbf/in <sup>2</sup>
Critical Section Area	4.407	in <sup>2</sup>
Pipe Body Yield Strength	485	kips
Min Internal Yield Pressure	14,420	psi
Collapse Pressure	14,340	psi

#### Connection

Coupling OD	5.000	inches
Coupling Length	7.875	inches
Make Up Loss	3.938	inches
Critical Section Area	4.472	in <sup>2</sup>
Internal Pressure Rating	100%	
External Pressure Rating	100%	
Tension Efficiency	100%	
Connection Strength	485	kips
Compression Efficiency	100%	
Uniaxial Bend Rating	100.9	° / 100 ft
Min Make Up Torque	3,550	ft-lbs
Yield Torque	13,700	ft-lbs

v1.2

7/26/2018

This documentation contains confidential and proprietary information not to be reproduced or divulged in whole or in part to anyone outside of your company without prior written authorization from Precision Connections, LLC, and such documentation and information is provided to you upon such conditions of confidentiality.

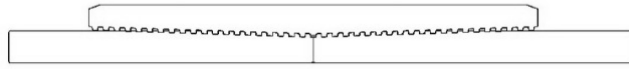

**Torque Data Sheet - Precision Connections BK**

**4.5 in. 15.1 lb/ft P-110 with 5 in. Coupling OD**

Min Make Up Torque	3,550	ft-lbs	Max Operating Torque	11,650	ft-lbs
Max Make Up Torque	10,300	ft-lbs	Yield Torque	13,700	ft-lbs
Optimum Torque	4,950	ft-lbs			

**Representative Torque Turn Graph**

