

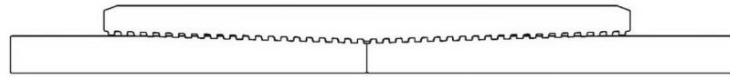

Keeping You Connected.



SEMI PREMIUM CONNECTIONS  
FIELD TESTED. FIELD PROVEN.

## Precision Connections BK

### 5.5 in. 20 lb/ft Q-125 with 6.05 in. Coupling OD

#### Pipe Body

Nominal OD	5.500	inches
Nominal Weight	20.00	lb/ft
Wall Thickness	0.361	inches
Plain End Weight	19.81	lb/ft
Drift	4.653	inches
Nominal ID	4.778	inches
Grade	Q-125	
Min Yield	125,000	lbf/in <sup>2</sup>
Min Tensile	135,000	lbf/in <sup>2</sup>
Critical Section Area	5.828	in <sup>2</sup>
Pipe Body Yield Strength	729	kips
Min Internal Yield Pressure	14,360	psi
Collapse Pressure	12,080	psi

#### Connection

Coupling OD	6.050	inches
Coupling Length	8.250	inches
Make Up Loss	4.125	inches
Critical Section Area	6.031	in <sup>2</sup>
Internal Pressure Rating	100%	
External Pressure Rating	100%	
Tension Efficiency	100%	
Connection Strength	729	kips
Compression Efficiency	100%	
Uniaxial Bend Rating	94.7	° / 100 ft
Min Make Up Torque	6,800	ft-lbs
Yield Torque	26,150	ft-lbs

v1.2

7/26/2018

This documentation contains confidential and proprietary information not to be reproduced or divulged in whole or in part to anyone outside of your company without prior written authorization from Precision Connections, LLC, and such documentation and information is provided to you upon such conditions of confidentiality.

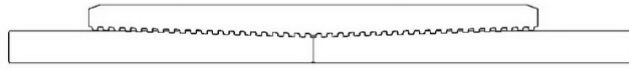

## Torque Data Sheet - Precision Connections BK

5.5 in. 20 lb/ft Q-125 with 6.05 in. Coupling OD

Min Make Up Torque	6,800	ft-lbs	Max Operating Torque	22,200	ft-lbs
Max Make Up Torque	19,600	ft-lbs	Yield Torque	26,150	ft-lbs
Optimum Torque	9,400	ft-lbs			

**Representative Torque Turn Graph**

