



Keeping You Connected.



SEMI PREMIUM CONNECTIONS FIELD TESTED. FIELD PROVEN.

## Precision Connections BK

### 9.625 in. 36 lb/ft P-110 with 10.625 in. Coupling OD

#### Pipe Body

Nominal OD	9.625	inches
Nominal Weight	36.00	lb/ft
Wall Thickness	0.352	inches
Plain End Weight	34.86	lb/ft
Drift	8.765	inches
Nominal ID	8.921	inches
Grade	P-110	
Min Yield	110,000	lbf/in <sup>2</sup>
Min Tensile	125,000	lbf/in <sup>2</sup>
Critical Section Area	10.254	in <sup>2</sup>
Pipe Body Yield Strength	1128	kips
Min Internal Yield Pressure	7,040	psi
Collapse Pressure	2,480	psi

#### Connection

Coupling OD	10.625	inches
Coupling Length	9.625	inches
Make Up Loss	4.813	inches
Critical Section Area	18.558	in <sup>2</sup>
Internal Pressure Rating	100%	
External Pressure Rating	100%	
Tension Efficiency	100%	
Connection Strength	1128	kips
Compression Efficiency	100%	
Uniaxial Bend Rating	47.4	° / 100 ft
Min Make Up Torque	10,000	ft-lbs
Yield Torque	61,000	ft-lbs

v1.2

7/26/2018

This documentation contains confidential and proprietary information not to be reproduced or divulged in whole or in part to anyone outside of your company without prior written authorization from Precision Connections, LLC, and such documentation and information is provided to you upon such conditions of confidentiality.

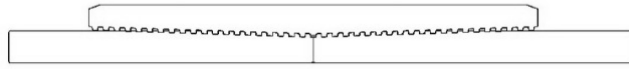

**Torque Data Sheet - Precision Connections BK**

**9.625 in. 36 lb/ft P-110 with 10.625 in. Coupling OD**

Min Make Up Torque	10,000 ft-lbs	Max Operating Torque	51,850 ft-lbs
Max Make Up Torque	45,750 ft-lbs	Yield Torque	61,000 ft-lbs
Optimum Torque	20,000 ft-lbs		

**Representative Torque Turn Graph**

