



Keeping You Connected.



SEMI PREMIUM CONNECTIONS
FIELD TESTED. FIELD PROVEN.

Precision Connections BK-HT

7 in. 26 lb/ft HC-L80 with 7.875 in. Coupling OD

Pipe Body

Nominal OD	7.000	inches
Nominal Weight	26.00	lb/ft
Wall Thickness	0.362	inches
Plain End Weight	25.66	lb/ft
Drift	6.151	inches
Nominal ID	6.276	inches
<hr/>		
Grade	HC-L80	
Min Yield	80,000	lbf/in ²
Min Tensile	95,000	lbf/in ²
Critical Section Area	7.549	in ²
Pipe Body Yield Strength	604	kips
Min Internal Yield Pressure	7,240	psi
Collapse Pressure	6,370	psi

Connection

Coupling OD	7.875	inches
Coupling Length	9.000	inches
Make Up Loss	4.500	inches
Critical Section Area	11.859	in ²
Internal Pressure Rating	100%	
External Pressure Rating	100%	
Tension Efficiency	100%	
Connection Strength	604	kips
Compression Efficiency	100%	
Uniaxial Bend Rating	46.5	° / 100 ft
Min Make Up Torque	6,700	ft-lbs 
Yield Torque	25,800	ft-lbs 

v1.2

7/26/2018

This documentation contains confidential and proprietary information not to be reproduced or divulged in whole or in part to anyone outside of your company without prior written authorization from Precision Connections, LLC, and such documentation and information is provided to you upon such conditions of confidentiality.

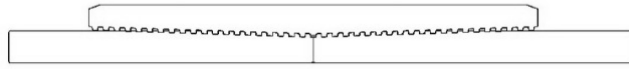

Torque Data Sheet - Precision Connections BK-HT

7 in. 26 lb/ft HC-L80 with 7.875 in. Coupling OD

Min Make Up Torque	6,700	ft-lbs	Max Operating Torque	21,950	ft-lbs
Max Make Up Torque	19,350	ft-lbs	Yield Torque	25,800	ft-lbs
Optimum Torque	9,300	ft-lbs			

Representative Torque Turn Graph

