



Keeping You Connected.



SEMI PREMIUM CONNECTIONS  
FIELD TESTED. FIELD PROVEN.

## Precision Connections BK-HT

### 7.625 in. 29.7 lb/ft P-110 with 8.5 in. Coupling OD

#### Pipe Body

Nominal OD	7.625	inches
Nominal Weight	29.70	lb/ft
Wall Thickness	0.375	inches
Plain End Weight	29.04	lb/ft
Drift	6.750	inches
Nominal ID	6.875	inches
Grade	P-110	
Min Yield	110,000	lbf/in <sup>2</sup>
Min Tensile	125,000	lbf/in <sup>2</sup>
Critical Section Area	8.541	in <sup>2</sup>
Pipe Body Yield Strength	940	kips
Min Internal Yield Pressure	9,470	psi
Collapse Pressure	5,350	psi

#### Connection

Coupling OD	8.500	inches
Coupling Length	9.375	inches
Make Up Loss	4.688	inches
Critical Section Area	13.063	in <sup>2</sup>
Internal Pressure Rating	100%	
External Pressure Rating	100%	
Tension Efficiency	100%	
Connection Strength	940	kips
Compression Efficiency	100%	
Uniaxial Bend Rating	59.3	° / 100 ft
Min Make Up Torque	10,000	ft-lbs
Yield Torque	43,300	ft-lbs

v1.2

7/26/2018

This documentation contains confidential and proprietary information not to be reproduced or divulged in whole or in part to anyone outside of your company without prior written authorization from Precision Connections, LLC, and such documentation and information is provided to you upon such conditions of confidentiality.

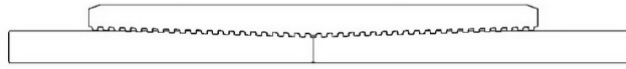

**Torque Data Sheet - Precision Connections BK-HT**

**7.625 in. 29.7 lb/ft P-110 with 8.5 in. Coupling OD**

Min Make Up Torque	10,000	ft-lbs	Max Operating Torque	36,800	ft-lbs
Max Make Up Torque	32,500	ft-lbs	Yield Torque	43,300	ft-lbs
Optimum Torque	15,600	ft-lbs			

**Representative Torque Turn Graph**

