

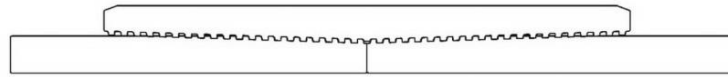

Keeping You Connected.



SEMI  
**PREMIUMCONNECTIONS**  
FIELD TESTED. FIELD PROVEN.

## Precision Connections BK-HT

7.625 in. 29.7 lb/ft Q-125 with 8.5 in. Coupling OD

### Pipe Body

Nominal OD	7.625	inches
Nominal Weight	29.70	lb/ft
Wall Thickness	0.375	inches
Plain End Weight	29.04	lb/ft
Drift	6.750	inches
Nominal ID	6.875	inches
Grade	Q-125	
Min Yield	125,000	lbf/in <sup>2</sup>
Min Tensile	135,000	lbf/in <sup>2</sup>
Critical Section Area	8.541	in <sup>2</sup>
Pipe Body Yield Strength	1068	kips
Min Internal Yield Pressure	10,760	psi
Collapse Pressure	5,670	psi

### Connection

Coupling OD	8.500	inches
Coupling Length	9.375	inches
Make Up Loss	4.688	inches
Critical Section Area	13.063	in <sup>2</sup>
Internal Pressure Rating	100%	
External Pressure Rating	100%	
Tension Efficiency	100%	
Connection Strength	1068	kips
Compression Efficiency	100%	
Uniaxial Bend Rating	67.4	° / 100 ft
Min Make Up Torque	10,000	ft-lbs
Yield Torque	49,200	ft-lbs

v1.2

7/26/2018

This documentation contains confidential and proprietary information not to be reproduced or divulged in whole or in part to anyone outside of your company without prior written authorization from Precision Connections, LLC, and such documentation and information is provided to you upon such conditions of confidentiality.

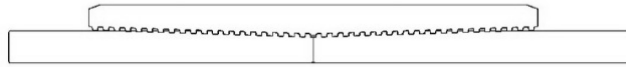

## Torque Data Sheet - Precision Connections BK-HT

7.625 in. 29.7 lb/ft Q-125 with 8.5 in. Coupling OD

Min Make Up Torque 10,000 ft-lbs

Max Make Up Torque 36,900 ft-lbs

Optimum Torque 17,700 ft-lbs

Max Operating Torque 41,800 ft-lbs

Yield Torque 49,200 ft-lbs

### Representative Torque Turn Graph

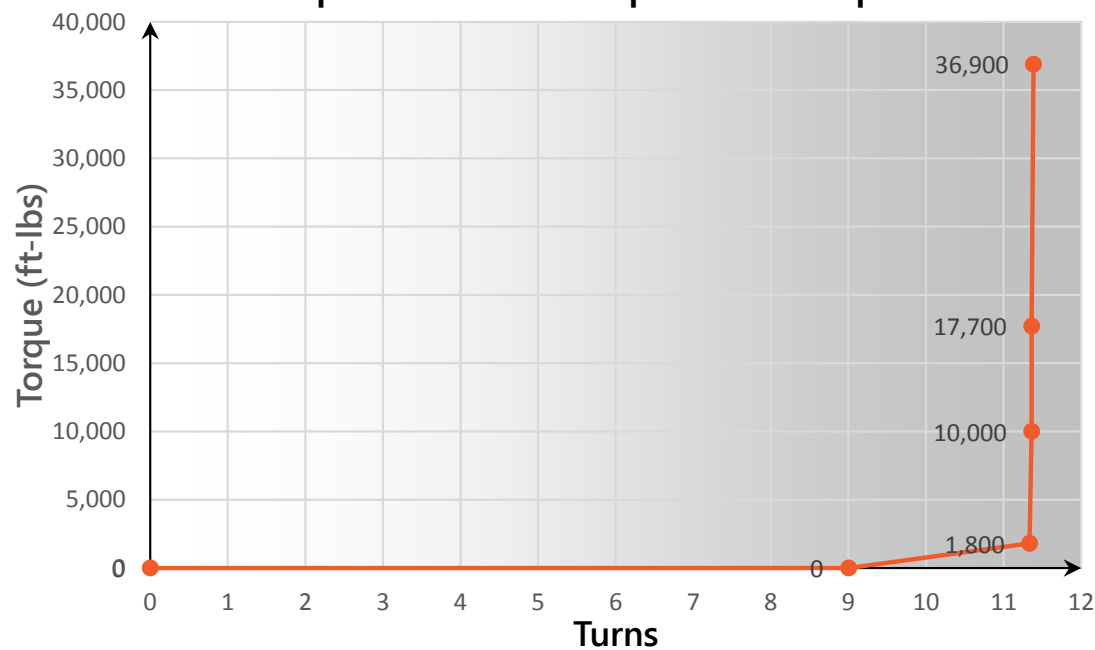

v1.2

7/26/2018