

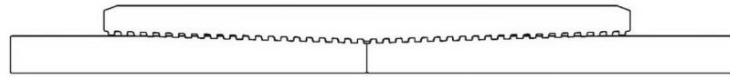

Keeping You Connected.



SEMI PREMIUM CONNECTIONS  
FIELD TESTED. FIELD PROVEN.

## Precision Connections BK-HT

### 4.5 in. 11.6 lb/ft L-80 with 5.25 in. Coupling OD

#### Pipe Body

Nominal OD	4.500	inches
Nominal Weight	11.60	lb/ft
Wall Thickness	0.25	inches
Plain End Weight	11.35	lb/ft
Drift	3.875	inches
Nominal ID	4.000	inches
Grade	L-80	
Min Yield	80,000	lbf/in <sup>2</sup>
Min Tensile	95,000	lbf/in <sup>2</sup>
Critical Section Area	3.338	in <sup>2</sup>
Pipe Body Yield Strength	267	kips
Min Internal Yield Pressure	7,780	psi
Collapse Pressure	6,350	psi

#### Connection

Coupling OD	5.250	inches
Coupling Length	7.875	inches
Make Up Loss	3.938	inches
Critical Section Area	6.484	in <sup>2</sup>
Internal Pressure Rating	100%	
External Pressure Rating	100%	
Tension Efficiency	100%	
Connection Strength	267	kips
Compression Efficiency	100%	
Uniaxial Bend Rating	69.8	° / 100 ft
Min Make Up Torque	2,150	ft-lbs
Yield Torque	8,350	ft-lbs

v1.2

7/26/2018

This documentation contains confidential and proprietary information not to be reproduced or divulged in whole or in part to anyone outside of your company without prior written authorization from Precision Connections, LLC, and such documentation and information is provided to you upon such conditions of confidentiality.

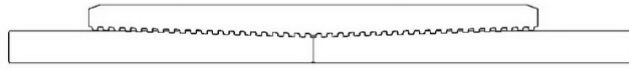

**Torque Data Sheet - Precision Connections BK-HT**

**4.5 in. 11.6 lb/ft L-80 with 5.25 in. Coupling OD**

Min Make Up Torque	2,150	ft-lbs	Max Operating Torque	7,100	ft-lbs
Max Make Up Torque	6,250	ft-lbs	Yield Torque	8,350	ft-lbs
Optimum Torque	3,000	ft-lbs			

**Representative Torque Turn Graph**

