

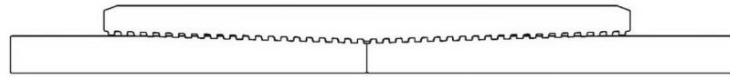

Keeping You Connected.



SEMI PREMIUM CONNECTIONS  
FIELD TESTED. FIELD PROVEN.

## Precision Connections BK-HT

### 5.5 in. 17 lb/ft P-110 with 6.3 in. Coupling OD

#### Pipe Body

Nominal OD	5.500	inches
Nominal Weight	17.00	lb/ft
Wall Thickness	0.304	inches
Plain End Weight	16.87	lb/ft
Drift	4.767	inches
Nominal ID	4.892	inches
Grade	P-110	
Min Yield	110,000	lbf/in <sup>2</sup>
Min Tensile	125,000	lbf/in <sup>2</sup>
Critical Section Area	4.962	in <sup>2</sup>
Pipe Body Yield Strength	546	kips
Min Internal Yield Pressure	10,640	psi
Collapse Pressure	7,480	psi

#### Connection

Coupling OD	6.300	inches
Coupling Length	8.250	inches
Make Up Loss	4.125	inches
Critical Section Area	8.456	in <sup>2</sup>
Internal Pressure Rating	100%	
External Pressure Rating	100%	
Tension Efficiency	100%	
Connection Strength	546	kips
Compression Efficiency	100%	
Uniaxial Bend Rating	80.0	° / 100 ft
Min Make Up Torque	6,900	ft-lbs
Yield Torque	26,500	ft-lbs

v1.2

7/26/2018

This documentation contains confidential and proprietary information not to be reproduced or divulged in whole or in part to anyone outside of your company without prior written authorization from Precision Connections, LLC, and such documentation and information is provided to you upon such conditions of confidentiality.

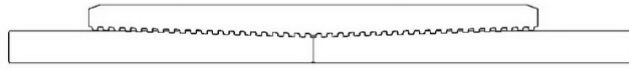

**Torque Data Sheet - Precision Connections BK-HT**

**5.5 in. 17 lb/ft P-110 with 6.3 in. Coupling OD**

Min Make Up Torque	6,900	ft-lbs	Max Operating Torque	22,550	ft-lbs
Max Make Up Torque	19,900	ft-lbs	Yield Torque	26,500	ft-lbs
Optimum Torque	9,550	ft-lbs			

**Representative Torque Turn Graph**

